



Quote Number:
Opportunity Number: 22003070
Sourcewell Contract #: 110421-ALT
Date: 10/25/2022

Quoted for: Turner USD 202
Customer Contact: Chris Crockett
Phone: 1-785-250-4590 / Email: crockett@turnerusd202.org
Quoted by: Nick Adcock
Phone: 919-529-3582 / Email: nick.adcock@altec.com
Altec Account Manager: Ben Crane

REFERENCE ALTEC MODEL		Sourcewell Price
AT41M	Articulating Telescopic Aerial Device with Material Handling Insulated, 41'	\$205,024

(A.) SOURCEWELL OPTIONS ON CONTRACT (Unit)

1	AT41M-US41S	Articulating Telescopic Aerial Device (Non-Insulated AT41S, Includes Inverter)	\$5,660
2	AT41M-AOR	Auxiliary Outriggers, Interlock, Wooden Pads / Holders (AT48M Class 5 application only)	\$9,013
3	AT41M-US48M	Articulating telescopic Aerial Device with Material Handling (insulating lower arm) with 48' boom boom height (AT48M)	\$7,625
4			

(A1.) SOURCEWELL OPTIONS ON CONTRACT (General)

1	fe	POWER EQUIPMENT (Power Locks and Power Windows)	\$1,352
2	th5	TOOL HOLDER FOR IMPACT WRENCHES AND DRILLS. Clip-On Type for Platform With or Without Liner. Keeps Tool Outside of Platform for Optimum Room.	\$356
3	pswi4	PURE SINE WAVE INVERTER. 3000 Watts Continuous. GFCI Outlet at Rear.	\$4,620
4	vcam	Backup Camera System	\$1,313
5			
6			
7			
8			
SOURCEWELL OPTIONS TOTAL:			\$234,963

(B.) OPEN MARKET ITEMS (Customer Requested)

1	UNIT		\$0
2	UNIT & HYDRAULIC ACC		\$0
3	BODY		\$0
4	BODY & CHASSIS ACC	(2) Top Opening Box- 132" x Width of Body x 20"T- hasp locks- Two treadplate lids each	\$5,471
5	ELECTRICAL	Deduct stock 2400 watt inverter	-\$4,323
6	FINISHING		\$0
7	CHASSIS	MY23 Stock Dodge chassis	-\$13,114
8	OTHER	MY23 Stock Build	-\$34,441
OPEN MARKET OPTIONS TOTAL:			-\$46,407

SUB-TOTAL FOR UNIT/BODY/CHASSIS: \$188,556
Delivery to Customer: \$3,192
TOTAL FOR UNIT/BODY/CHASSIS: \$191,748

(C.) ADDITIONAL ITEMS (items are not included in total above)

1		5 Year Altec Extended Warranty- TLME- OPTION	\$6,700
2			
3			

Pricing valid for 45 days

NOTES

PRICING: Altec will make every effort to honor this quotation, subject to the following provisions. Prices for equipment with production start dates 12 months and beyond are budgetary only due to irregular cost inflation and market volatility. These prices will be reviewed based on market conditions and confirmed closer to the production date. For a quoted chassis model year beyond the current open order bank, chassis model year, specifications and price should be considered estimates only and subject to change. Chassis model year, specifications and price will be reviewed and confirmed when specific model year information becomes available from the OEM.

PAINT COLOR: White to match chassis, unless otherwise specified

WARRANTY: Standard Altec Warranty for Aerials and Derricks - One (1) year parts warranty One (1) year labor warranty Ninety (90)

TO ORDER: To order, please contact the Altec Account Manager listed above.

CHASSIS: Per Altec Commercial Standard

DELIVERY: No later than 10-11 months ARO, FOB Customer Location

TERMS: Net 30 days

BEST VALUE: Altec boasts the following "Best Value" features: Altec ISO Grip Controls for Extra Protection, Only Lifetime Warranty on Structural Components in Industry, Largest Service Network in Industry (Domestic and Overseas), Altec SENTRY Web/CD Based Training, Dedicated/Direct Gov't Sales Manager, In-Service Training with Every Order.

TRADE-IN: Please ask your Altec Account Manager for more information

BUILD LOCATION: Creedmoor, N.C



Quote Number: 1097997 - 2
Altec, Inc.

October 19, 2022
Our 93rd Year

Ship To:

ALTEC INDUSTRIES PLANT 227 CREEDMOOR FINAL ASSY
BURNSVILLE BODY PLANT
150 ALTEC DRIVE
BURNSVILLE, NC 28714
US

Bill To:

ALTEC INDUSTRIES PLANT 227 CREEDMOOR FINAL ASSY
CREEDMOOR FINAL ASSEMBLY
1550 AERIAL AVE
CREEDMOOR, NC 27522-0000
United States

Attn:
Phone:
Email:

Altec Quotation Number: 1097997 - 2
Account Manager: Unassigned-Preferred Configuration
Technical Sales Rep: Keith Clement

<u>Item</u>	<u>Description</u>	<u>Qty</u>
	<u>Unit</u>	
1.	Altec Model AT41S Articulating Telescopic Aerial Device, non-insulating with proportional joystick upper controls. Built in accordance to ALTEC's standard specifications and to include the following features: <ul style="list-style-type: none">A. Ground to Bottom of Platform Height: 40.5 feet at 8.3 feet from centerline of rotation (12.33 m at 2.54 m)B. Working Height: 45.5 feet (13.85 m)C. Maximum reach to edge of platform with Upper Boom Non- overcenter: 30.5 feet (at 17.0 feet platform height)D. Upper boom extension: 110 inchesE. Continuous rotationF. Articulating Arm: Articulation is from -3 to 82 degrees. Insulator provides 19 inches of isolation.G. Compensation System: By raising the articulating arm only, the telescopic boom maintains its relative angle in relation to the ground. The work position is achieved through a single function operation.H. Upper Boom: Articulation is from -25 to 85 degrees. The fiberglass section provides a minimum of 10.9 inches of isolation in the upper boom (when retracted and 42.3 inches when extended).I. Platform leveling is achieved by a hydraulic master-slave leveling system. This lifetime system is very low maintenance.J. Control System:<ul style="list-style-type: none">1) Control Handle: A single handle controller. The control handle is black in color. The handle also includes an interlock guard that reduces the potential for inadvertent boom operation.2) Auxiliary Control Covers: Non-tested blue silicon covers for auxiliary controls.3) Control Console: Non-tested non-metallic control console plate.4) Boom Tip Covers: Non-tested non-metallic boom tip covers. The covers are not dielectrically tested, but they may provide some protection against electrical hazards.K. Hydraulic system: Open center (full pressure), maximum flow 6 GPM, maximum operating pressure 3,000.	1

We Wish To Thank You For Giving Us The Pleasure
And Opportunity of Serving You

UTILITY EQUIPMENT AND BODIES SINCE 1929

<u>Item</u>	<u>Description</u>	<u>Qty</u>
	<p>M. Unit is painted with a powder coat paint process which provides a finish-painted surface that is highly resistant to chipping, scratching, abrasion and corrosion. Paint is electrostatically applied to the inside as well as outside of fabricated parts then high temperature cured prior to assembly ensuring maximum coverage and protection.</p> <p>N. Manuals: Two (2) Operator's and two (2) Maintenance/ Parts manuals containing instructional markings indicating hazards inherent in the operation of an aerial device.</p> <p>O. Unit meets or exceeds ANSI 92.2 standards.</p>	
2.	Pedestal	1
3.	Single 2-Man Platform, Aluminum (Non-Insulated), 60" x 36" x 45", End Mount, 180 Degree Rotation.	1
4.	Platform Mounted Single Handle Controls	1
5.	Material Handling Jib/Winch, Hydraulically Articulating, Top Mounted, Round (ARM Jib)	1
6.	Rubber Floor Liner With Drainage For 60 x 36 x 45 inch (1524 x 914 x 1143 mm) aluminum platform	1
7.	Hydraulic Tool Circuit at Platform: Control easily accessible to the operator activates the tool circuit. One set of hydraulic tool outlets at the boom tip; they consist of one set of quick disconnect couplings at the platform, a valve assembly inside the control cover, and detented control handle. Operates open center tools	1
8.	Engine Start/Stop & Secondary Stowage System: 12 VDC powered motor and pump assembly for temporary operation of the unit in a situation wherein the primary hydraulic source fails. Electric motor is powered by the chassis battery. This feature allows the operator to completely stow the booms, platform, and outriggers. Secondary Stowage & Start/Stop is activated with an air plunger at the platform or momentary switch at the lower control station and outriggers.	1
9.	120 Volt Receptacle Installed At Platform	1
10.	Jib Stick, 52" L, Extension Dependent, Non-Certified, grey in color	1
11.	Platform Mounted Extendible Supports for Holding Signs	1
12.	Slip Ring: Required for engine start/stop, secondary stowage system, and throttle control options	1
13.	Outriggers, Primary, Modified A-Frame With Integrated Subbase, 30"-34" Chassis Height, Electric Interlock, No Valves On Legs, 114" Spread, Fixed Shoe (AT37/41 M/ME/P/PE/S/SE)	1
14.	Lifting Eye - lifting eye on underside of lower boom. Rated at 1,000lbs (454kg) lifting capacity.	1
15.	Winch load line swivel hook	1
16.	Attec Unit Powder Painted White	1

Unit & Hydraulic Acc.

We Wish To Thank You For Giving Us The Pleasure
And Opportunity of Serving You

UTILITY EQUIPMENT AND BODIES SINCE 1929

<u>Item</u>	<u>Description</u>	<u>Qty</u>
17.	Electric Outrigger Controls for one (1) set of outriggers, drive hydraulic outrigger control valves. Durable weather proof sealed electronic switches mounted in aluminum boxes located at the rear of the unit unless otherwise specified.	1
18.	Steel Reservoir, 15 gallon capacity, triangular, 17" L x 17" W x 24" H, and includes breather caps and dipsticks	1
19.	Temperature Sight Gauge	1
20.	HVI-22 Hydraulic Oil (Standard).	25
21.	Standard Pump For PTO	1
22.	Electric Shifted PTO	1
23.	Standard PTO/Transmission Functionality for Small Ford and Dodge Chassis	1

Body

- | | | |
|-----|--|---|
| 24. | 132 inch Universal Aerial Body with outrigger housings, suitable for installing on any chassis with an approximate CA dimension of 84 inches, built in accordance with the following specifications: | 1 |
|-----|--|---|
- A. Basic body fabricated from A40 grade 100% zinc alloy coated steel.
 - B. All doors are full, double paneled, self-sealed with built-in drainage.
 - C. Stainless steel hinge rods extend full length of door.
 - D. Door hinges are zinc alloy material attached with rivets.
 - E. All doors contain stainless steel, flush mounted, paddle activated rotary style latches with two-stage locking, including keyed locks and adjustable strikers.
 - F. Heavy-gauge welded steel frame construction with structural channel crossmembers and smooth plate floor.
 - G. All edges are either rolled or folded for strength and safety.
 - H. Door header drip rail at top for maximum weather protection.
 - I. Neoprene or rolled fenders on wheel fender panels.
 - J. Steel treated for improved primer bond and rust resistance.
 - K. Automotive underseal applied to body.
 - L. Automotive type non-porous door seals mechanically fastened to the door facing.
 - M. 132 Inch Body Length
 - N. 40 Inch Body Height (Standard)
 - O. 94 Inch Body Width (Standard)
 - P. 20 Inch Body Compartment Depth (Standard)
 - Q. Body Color - White (Standard)
 - R. Finish Paint Body At Body Manufacturer (Standard)
 - S. 6 Inch Tall Wooden Tailboard Installed At The Rear of Body Cargo Area
 - T. Stainless Steel Rotary Paddle Latch With Lock (Standard)
 - U. Master Body Locking System (Standard)
 - V. One Chock Holder On Each Side of Body With Retaining Lip In Fender Panel (Standard)
 - W. Gas Shock Type Rigid Door Holders For Vertical Doors (Standard)
 - X. Chains On Horizontal Doors
 - Y. Hotstick Shelf Extending From Rear Of First Vertical To Rear Of Body On Curbside, With Standard Sized Drop-Down Door
 - Z. Hotstick Shelf Extending Full Length Of Body On Streetside, With Standard Sized

We Wish To Thank You For Giving Us The Pleasure
And Opportunity of Serving You

UTILITY EQUIPMENT AND BODIES SINCE 1929

<u>Item</u>	<u>Description</u>	<u>Qty</u>
	Drop-Down Door	
AA.	1st Vertical Street Side (LH) - Two (2) Adjustable Shelves With Removable Dividers On 4 Inch Centers	
AB.	1st Vertical Street Side (LH) - Outrigger Housing, With Outrigger Pin Access As Needed	
AC.	2nd Vertical Street Side (LH) - Two (2) Adjustable Shelves With Removable Dividers On 4 Inch Centers	
AD.	1st Horizontal Street Side (LH) - Vacant	
AE.	Rear Vertical Street Side (LH) - One (1) Adjustable Shelf With Removable Dividers On 4 Inch Centers	
AF.	1st Vertical Curb Side (RH) - Two (2) Adjustable Shelves With Removable Dividers On 4 Inch Centers	
AG.	1st Vertical Curb Side (RH) - Inverter Storage Inside Of Body Compartment With Guard And Provisions For Remote GFCI Receptacle	
AH.	1st Vertical Curb Side (RH) - Outrigger Housing, With Outrigger Pin Access As Needed	
AI.	2nd Vertical Curb Side (RH) - Two (2) Adjustable Shelves With Removable Dividers On 4 Inch Centers	
AJ.	1st Horizontal Curb Side (RH) - Vacant	
AK.	Rear Vertical Street Side (RH) - One (1) Adjustable Shelf With Removable Dividers On 4 Inch Centers	
AL.	48 Tailshelf with Integrated Side Access Steps And One (1) Post-Style Grab Handle Installed To The Rear Of Access Steps	
AM.	One (1) Grab Handle Installed On Rear Of Curbside Sidepack	

Body and Chassis Accessories

25.	ICC (Underride Protection) Bumper Installed At Rear	1
26.	Receiver Hitch, 2", Class 3	1
27.	Set Of Eye Bolts for Trailer Safety Chain, installed one each side of towing device mount.	1
28.	Install Front Bumper with Counterweight	1
29.	Rigid Step Mounted Beneath Side Access Steps (Installed To Extend Approx. 2" Outward)	1
30.	Platform Rest, Rigid with Rubber Tube	1
31.	Boom Rest for a Telescopic Unit	1
32.	Wood Outrigger Pad, 19" x 19" x 2.5", With Rope Handle	2
33.	Outrigger Pad Holder, 20" L x 20" W x 3" H Front - 5" H Rear (Sloped), Fits 19.5" x 19.5" x 2" and Smaller Pads, Bolt-On, Bottom Washout Holes, 3/4" Lip Retainer	2
34.	Pendulum Retainers For Outrigger Pad Holders	2
35.	Mud Flaps With Altec Logo (Pair)	1
36.	Wheel Chocks, Rubber, 9.75" L x 7.75" W x 5.00" H, with 4" L Metal Hairpin Style Handle (Pair)	1

We Wish To Thank You For Giving Us The Pleasure
And Opportunity of Serving You

UTILITY EQUIPMENT AND BODIES SINCE 1929

<u>Item</u>	<u>Description</u>	<u>Qty</u>
37.	Slope Indicator Assembly (Pair) For Machine With Outriggers	1
38.	Safety Harness & 4.5 FT Lanyard (Medium To X-large)	2
39.	Driveaway Safety Kit	1
40.	Vinyl manual pouch for storage of all operator and parts manuals	1
41.	Soft Vinyl Lanyard Pouch	1
<u>Electrical Accessories</u>		
42.	Lights and reflectors in accordance with FMVSS #108 lighting package. (Complete LED, including LED reverse lights)	1
43.	4-Corner Strobes, Amber, LED, Two (2) Surface Mounted Lights In Grille, Two (2) Round Lights At Rear	1
44.	Strobe Beacon, Amber LED, With Brush Guard, Installed On Post At Front Of Body, One (1) Each Side (Standard) (Federal Signal #420221-02)	1
45.	Dual Tone Back-Up With Outrigger Motion Alarm	1
46.	PTO Hour Meter, Digital, with 10,000 Hour Display	1
47.	7-Way Trailer Receptacle (Blade Type) Installed At Rear	1
48.	Ford Upfitter Switches (Supplied with Chassis)	1
49.	Inverter, 2400 Watt, Pure Sine Wave, 120 VAC (Sensata #12/2400N) CS 1st Vertical	1
50.	Inverter Wired Battery Hot (No Dash Mounted Switch)	1
51.	Install inverter inside 1st vertical compartment on curbside.	1
52.	120 Volt GFCI Receptacle, includes weather-resistant enclosure. Installed at front of body on curbside.	1
53.	GFCI Receptacle Hardwired To Protect Additional Non-GFCI Duplex Receptacles.	1
54.	Install Wiring for Additional Non-GFCI Receptacle Located at Platform (15 Amps Maximum)	1
55.	Power Distribution Module Is A Compact Self-Contained Electronic System That Provides A Standardized Interface With The Chassis Electrical System. (Includes Operator's Manual)	1
56.	Install secondary stowage system.	1
57.	Install Remote Start/Stop system in Final Assembly.	1
58.	Install Outrigger Interlock System	1
59.	Heavy Duty Secondary Stowage Pump	1

We Wish To Thank You For Giving Us The Pleasure
And Opportunity of Serving You

UTILITY EQUIPMENT AND BODIES SINCE 1929

<u>Item</u>	<u>Description</u>	<u>Qty</u>
60.	PTO Indicator Light Installed In Cab	1
<u>Finishing Details</u>		
61.	Powder Coat Unit Altec White	1
62.	Finish Paint Body Accessories Above Body Floor Altec White	1
63.	Altec Standard; Components mounted below frame rail shall be coated black by Altec. i.e. step bumpers, steps, frame extension, pintle hook mount, dock bumper mounts, D-rings, receiver tubes, accessory mounts, light brackets, under-ride protection, etc. Components mounted to under side of body shall be coated black by Altec. i.e. Wheel chock holders, mud flap brackets, pad carriers, boxes, lighting brackets, steps, and ladders.	1
64.	Apply Non-Skid Coating to all walking surfaces	1
65.	English Safety And Instructional Decals	1
66.	Vehicle Height Placard - Installed In Cab	1
67.	Placard, HVI-22 Hydraulic Oil	1
68.	Stability test unit according to ANSI requirements.	1
69.	Focus Factory Build	1
70.	Delivery Of Completed Unit	1
71.	Inbound Freight	1
72.	As Built Electrical And Hydraulic Schematics To Be Included In The Manual Pouch	1
73.	Stock Unit	1
<u>Chassis</u>		
74.	Altec Supplied Chassis	1
75.	Altec Stock Chassis	1
A.	2022 Model Year	
B.	Ford F550	
C.	Regular Cab	
D.	4x2 Drivetrain	
E.	Chassis Color - White	
F.	Ford 6.7L Power Stroke Diesel	
G.	330 HP Engine Rating	
H.	Ford Torqshift 10-Speed Automatic Transmission (w/PTO Provision)	
I.	Clear Cab to Axle Length - 84 inches	
J.	Wheelbase Length - 169 inches	
K.	19,500 LBS Gross Vehicle Weight Rating (GVWR)	
L.	7,500 LBS Front Axle Weight Rating (FAWR)	

We Wish To Thank You For Giving Us The Pleasure
And Opportunity of Serving You

UTILITY EQUIPMENT AND BODIES SINCE 1929

<u>Item</u>	<u>Description</u>	<u>Qty</u>
M.	14,706 LBS Rear Axle Weight Rating (RAWR)	
N.	Ford E/F250-550 Single Horizontal Right Side Exhaust	
O.	Hydraulic Brakes	
P.	Park Brake In Rear Wheels	
Q.	Ford 40 Gallon Fuel Tank (Rear)	
R.	Ford 7.2 Gallon DEF Tank (Mid Mount)	
S.	225/70R19.5 Front Tire	
T.	225/70R19.5 Rear Tire	
U.	98R - Operator Commanded Regeneration (OCR)	
V.	63C - Aft Axle Frame Extension	
W.	No Idle Engine Shut-Down Required	
X.	50-State Emissions	
Y.	Clean Idle Certification	
Z.	Air Conditioning	
AA.	AM/FM Radio	
AB.	Block Heater	
AC.	Bluetooth	
AD.	Cruise Control	
AE.	Keyless Entry	
AF.	Limited Slip Rear Axle	
AG.	Power Door Locks	
AH.	Power Mirrors with Heated Glass	
AI.	Power Windows	
AJ.	Tilt Steering Wheel	
AK.	Trailer Brake Controller (Factory Installed)	
AL.	Vinyl Split Bench Seat	

Additional Pricing

76.	Standard Altec Warranty: One (1) year parts warranty, one (1) year labor warranty, ninety (90) days warranty for travel charges, limited lifetime structural warranty	1
-----	---	---

Altec Industries, Inc.

BY _____

Keith Clement

Notes:

NOTE: ALL COMPARTMENTS SHOWN WITH OUTSIDE DIMENSIONS.
(ACCESS OPENING IS NARROWER UNLESS OTHERWISE SPECIFIED.)

REVISIONS			
REV	DESCRIPTION	DATE	DRAWN ORG EC #
A	RELEASED		

41" PEDESTAL HEIGHT

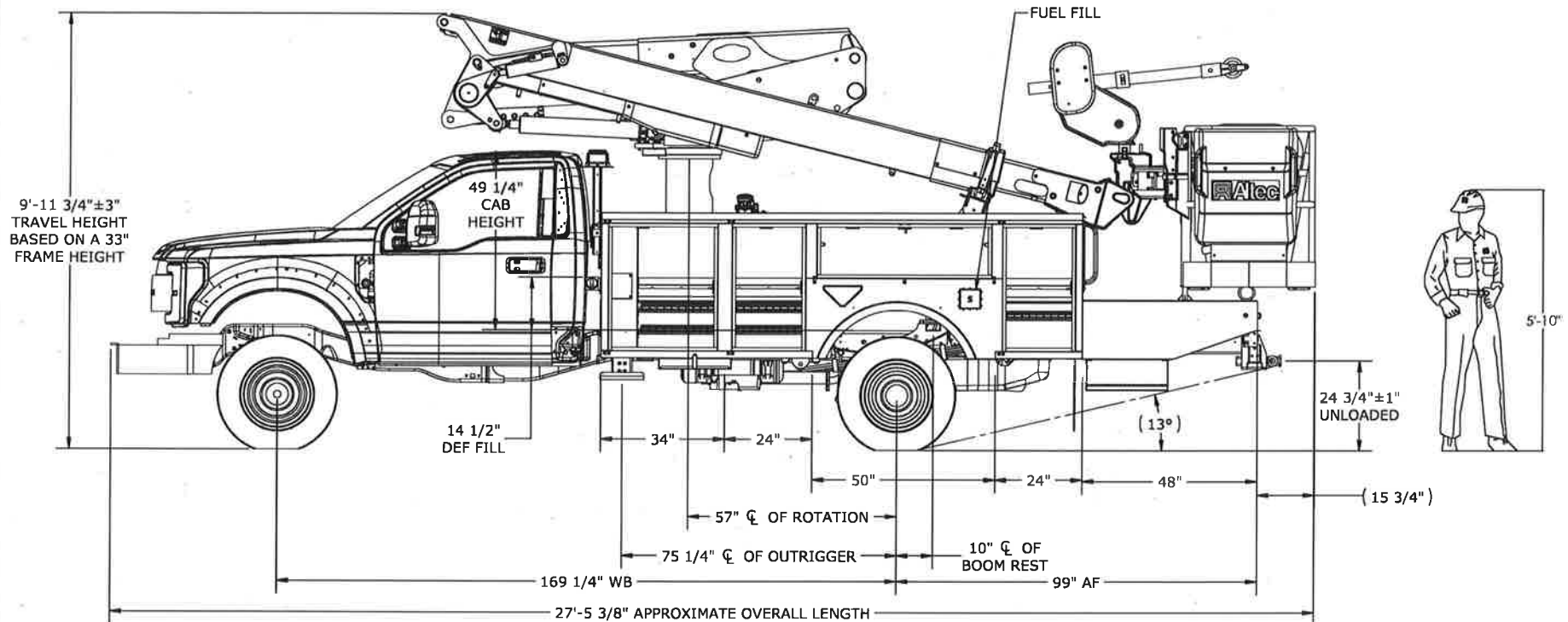

UNIT: AT41S
 SUBBASE HEIGHT: -
 BODY CROSSMEMBERS: -
 FLATBED CROSSMEMBERS: -
 CHASSIS MAKER: FORD
 CHASSIS MODEL: F550 4X2
 CHASSIS YEAR: 2022+

APPROVAL PRINT STAMP
☐ APPROVED
☐ APPROVED AS NOTED
☐ NOT APPROVED, CHANGE AS NOTED, RESUBMIT FOR APPROVAL.

NOTE: ANY CHANGES MAY AFFECT PRICE

RETURN OF APPROVAL PRINT REQ'D BY: -
 BY: _____ DATE: _____

RUN NO.: _____

NOTES: DO NOT SCALE THIS PRINT, REMOVE ALL BURRS & SHARP EDGES, ALL DIMENSIONS ARE IN INCHES.
CAD SOFTWARE: SOLIDWORKS.

CONFIDENTIAL:
 THIS DRAWING AND ITS CONTENTS ARE THE PROPRIETARY AND CONFIDENTIAL INFORMATION OF ALTEC INDUSTRIES, INC., AND ARE NOT TO BE REPRODUCED, COPIED, OR PUBLICLY DISCLOSED. IF THIS DRAWING IS PROVIDED TO A SOMEONE OUTSIDE ALTEC, IT IS DONE SO FOR THE LIMITED PURPOSE OF ASSISTING THAT RECIPIENT WITH A TECHNICAL OR PRODUCT ISSUE. IN RECEIVING THIS DRAWING, THE RECIPIENT AGREES TO MAINTAIN IT IN CONFIDENCE AND NOT TO USE IT BEYOND THE PURPOSE PREVIOUSLY STATED. RECIPIENT AGREES NOT TO REPRODUCE, COPY, OR PUBLICLY DISCLOSE THIS DRAWING AND ITS CONTENTS.

NAME	DATE	SHIFT
DRAWN BY: D. VENEGAS	02/04/2022	1 OF 9
CHECKED BY: -	-	-



Altec Industries, Inc.
 210 Inverness Center Drive
 Birmingham, AL 35242

SALES DRAWING
 LGS 132-84(B1)

SCALE	SHEET	NUMBER	REV
1:28	2	980008337	A

NOTE: CS COMPARTMENT WIDTHS ARE IDENTICAL TO THE SS

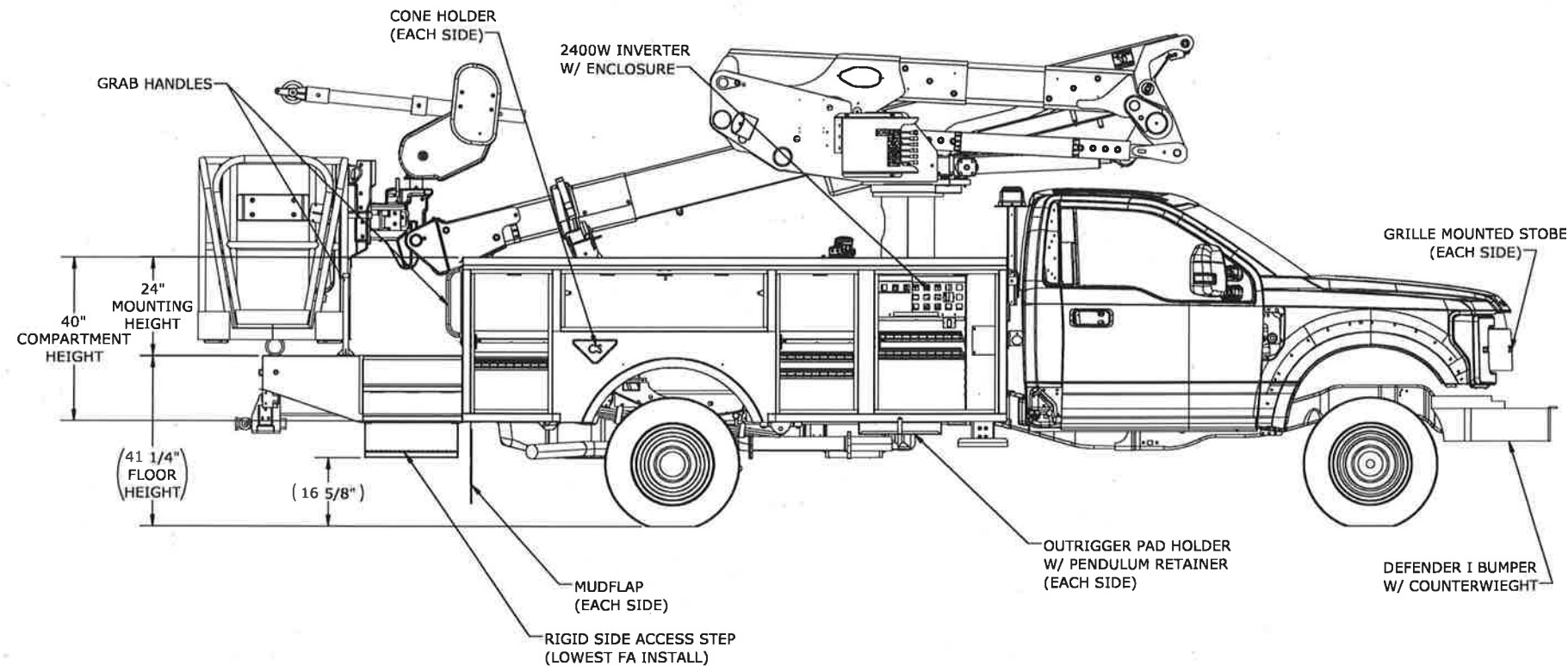

UNIT: AT41S
SUBBASE HEIGHT: -
BODY CROSSMEMBERS: -
FLATBED CROSSMEMBERS: -
CHASSIS MAKER: FORD
CHASSIS MODEL: F550 4X2
CHASSIS YEAR: 2022+

APPROVAL PRINT STAMP
☐ APPROVED
☐ APPROVED AS NOTED
☐ NOT APPROVED, CHANGE AS NOTED,
RESUBMIT FOR APPROVAL
NOTE: ANY CHANGES MAY AFFECT PRICE
RETURN OF APPROVAL PRINT REQ'D BY: -
BY: _____ DATE: _____

RUN NO.: -

NOTES: DO NOT SCALE THIS PRINT, REMOVE ALL BURRS & SHARP
EDGES. ALL DIMENSIONS ARE IN INCHES.
CAD SOFTWARE: SOLIDWORKS.

CONFIDENTIAL:
THIS DRAWING AND ITS CONTENTS ARE THE PROPRIETARY AND
CONFIDENTIAL INFORMATION OF ALTEC INDUSTRIES, INC., AND ARE
NOT TO BE REPRODUCED, COPIED, OR PUBLICLY DISCLOSED. IF THIS
DRAWING IS PROVIDED TO A SOMEONE OUTSIDE ALTEC, IT IS DONE
SO FOR THE LIMITED PURPOSE OF ASSISTING THAT RECIPIENT WITH A
TECHNICAL OR PRODUCT ISSUE. IN RECEIVING THIS DRAWING, THE
RECIPIENT AGREES TO MAINTAIN IT IN CONFIDENCE AND NOT TO
USE IT BEYOND THE PURPOSE PREVIOUSLY STATED. RECIPIENT
AGREES NOT TO REPRODUCE, COPY, OR PUBLICLY DISCLOSE THIS
DRAWING AND ITS CONTENTS.

DRAWN BY: D.VENEGAS DATE: 02/04/2022 SHEET: 2 OF 9
CHECKED BY: -

Altec

Altec Industries, Inc.
210 Inverness Center Drive
Birmingham, AL 35242

FILE: SALES DRAWING
LGS 132-84(B1)

SCALE: 1:25 SIZE: 2 NUMBER: 980008337 REV: A

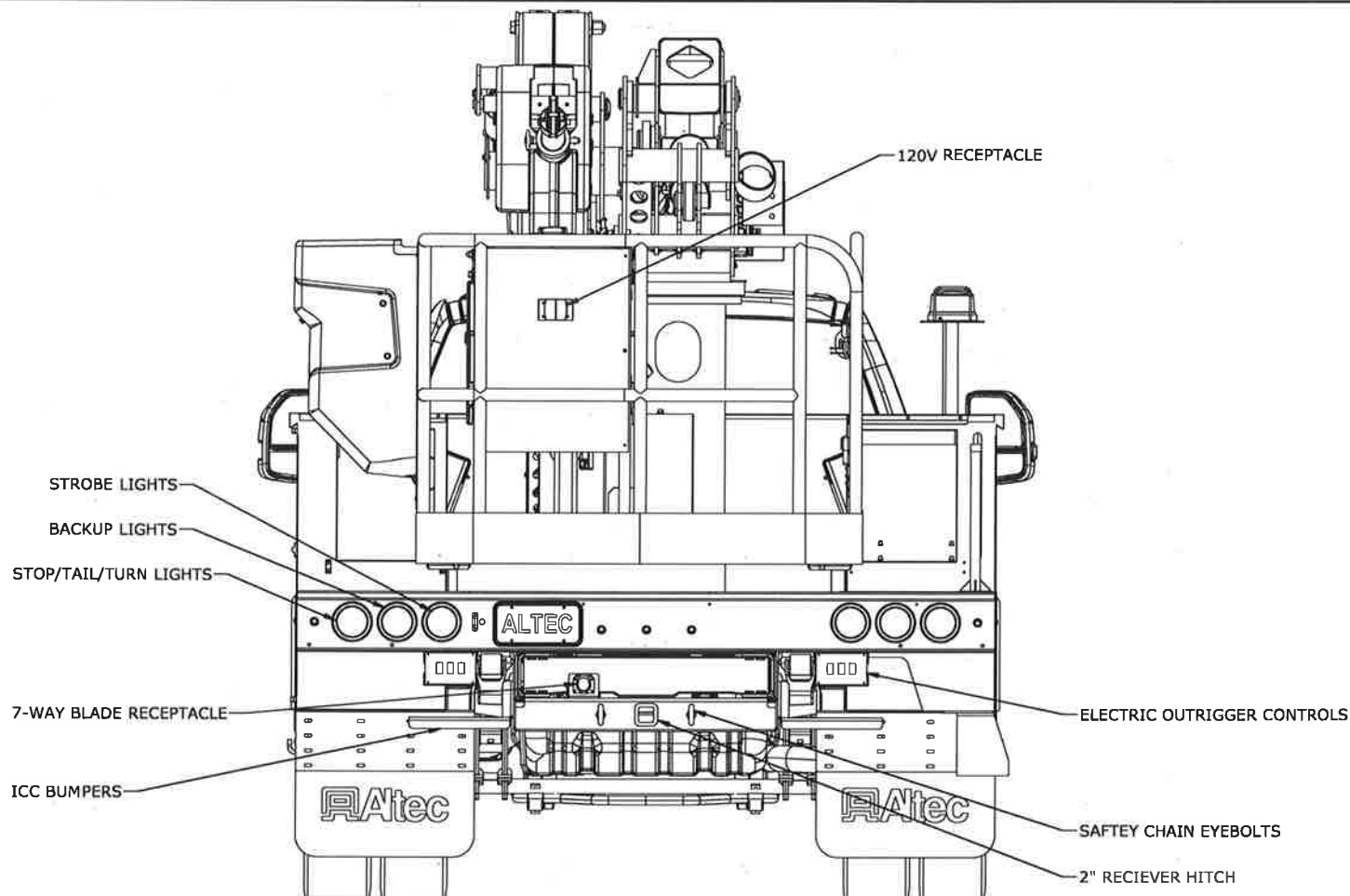

UNIT: AT41S
 SUBBASE HEIGHT: -
 BODY CROSSMEMBERS: -
 FLATBED CROSSMEMBERS: -
 CHASSIS MAKER: FORD
 CHASSIS MODEL: F550 4X2
 CHASSIS YEAR: 2022+

APPROVAL PRINT STAMP
☐ APPROVED
☐ APPROVED AS NOTED
☐ NOT APPROVED, CHANGE AS NOTED, RESUBMIT FOR APPROVAL.

NOTE: ANY CHANGES MAY AFFECT PRICE

RETURN OF APPROVAL PRINT REQ'D BY: -
 BY: _____ DATE: _____

RUN NO.: -

NOTES: DO NOT SCALE THIS PRINT, REMOVE ALL BURRS & SHARP EDGES, ALL DIMENSIONS ARE IN INCHES.
 CAD SOFTWARE: SOLIDWORKS.

CONFIDENTIAL:
 THIS DRAWING AND ITS CONTENTS ARE THE PROPRIETARY AND CONFIDENTIAL INFORMATION OF ALTEC INDUSTRIES, INC., AND ARE NOT TO BE REPRODUCED, COPIED, OR PUBLICLY DISCLOSED. IF THIS DRAWING IS PROVIDED TO A SOMEONE OUTSIDE ALTEC, IT IS DONE SO FOR THE LIMITED PURPOSE OF ASSISTING THAT RECIPIENT WITH A TECHNICAL OR PRODUCT ISSUE. IN RECEIVING THIS DRAWING, THE RECIPIENT AGREES TO MAINTAIN IT IN CONFIDENCE AND NOT TO USE IT BEYOND THE PURPOSE PREVIOUSLY STATED. RECIPIENT AGREES NOT TO REPRODUCE, COPY, OR PUBLICLY DISCLOSE THIS DRAWING AND ITS CONTENTS.

DRAWN BY:	NAME	DATE	SHEET	SCALE	SUB	NUMBER	REV
CHECKED BY:	D. VENEGAS	02/04/2022	3 OF 9	1:15	2	980008337	A

Altec Altec Industries, Inc.
 210 Inverness Center Drive
 Birmingham, AL 35242

SALES DRAWING
 LGS 132-84(81)

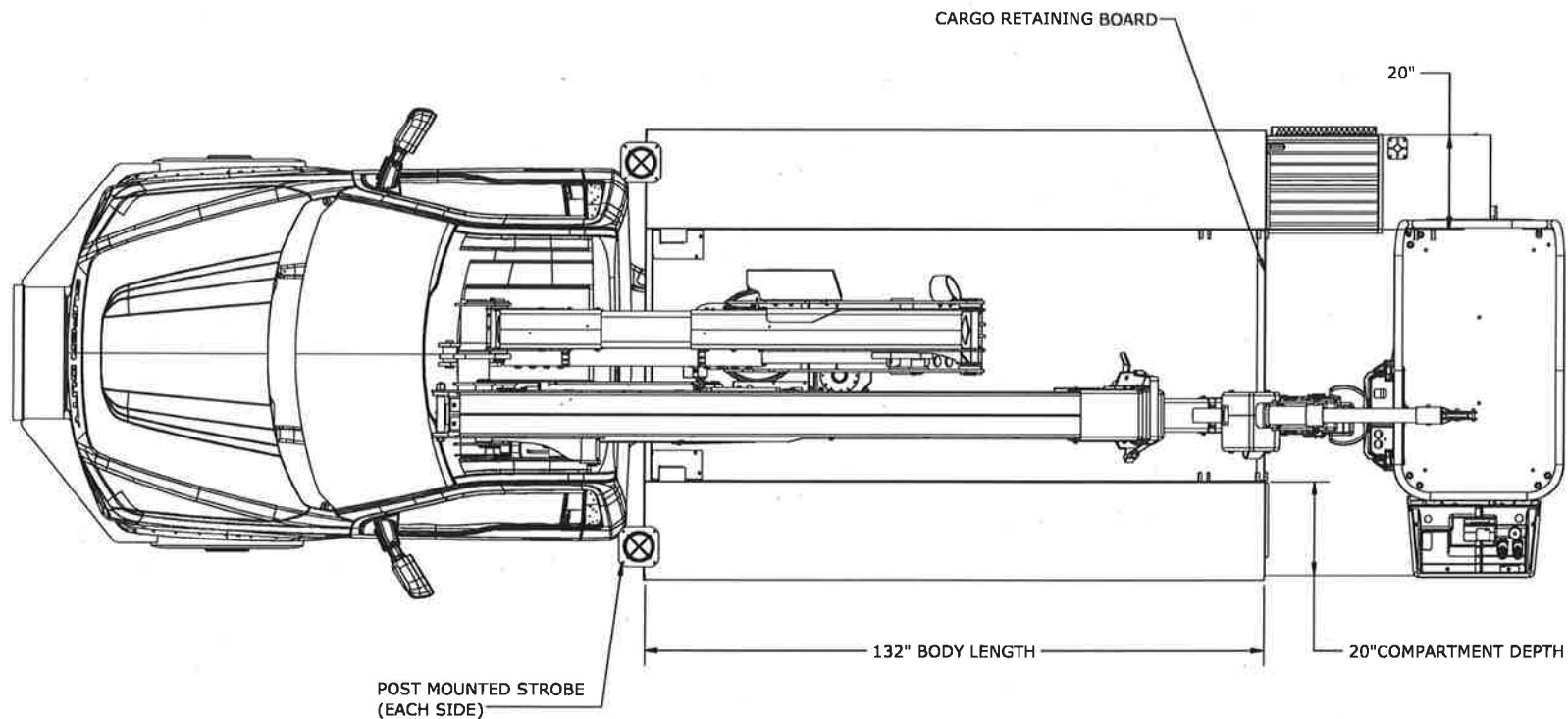

UNIT: AT41S

SUBBASE HEIGHT: -

BODY CROSSMEMBERS: -

FLATBED CROSSMEMBERS: -

CHASSIS MAKER: FORD

CHASSIS MODEL: F550 4X2

CHASSIS YEAR: 2022+

APPROVAL PRINT STAMP

- ☐ APPROVED
☐ APPROVED AS NOTED
☐ NOT APPROVED, CHANGE AS NOTED, RESUBMIT FOR APPROVAL.

NOTE: ANY CHANGES MAY AFFECT PRICE

RETURN OF APPROVAL PRINT REQ'D BY: -

BY: - DATE: -

RUN NO.: -

NOTES: DO NOT SCALE THIS PRINT. REMOVE ALL BURRS & SHARP EDGES. ALL DIMENSIONS ARE IN INCHES. CAD SOFTWARE: SOLIDWORKS.

CONFIDENTIAL: THIS DRAWING AND ITS CONTENTS ARE THE PROPRIETARY AND CONFIDENTIAL INFORMATION OF ALTEC INDUSTRIES, INC., AND ARE NOT TO BE REPRODUCED, COPIED, OR PUBLICLY DISCLOSED. IF THIS DRAWING IS PROVIDED TO A SOMEONE OUTSIDE ALTEC, IT IS DONE SO FOR THE LIMITED PURPOSE OF ASSISTING THAT RECIPIENT WITH A TECHNICAL OR PRODUCT ISSUE. IN RECEIVING THIS DRAWING, THE RECIPIENT AGREES TO MAINTAIN IT IN CONFIDENCE AND NOT TO USE IT BEYOND THE PURPOSE PREVIOUSLY STATED. RECIPIENT AGREES NOT TO REPRODUCE, COPY, OR PUBLICLY DISCLOSE THIS DRAWING AND ITS CONTENTS.

DRAWN BY:	NAME	DATE	SHEET
D. VENEGAS		02/04/2022	4 OF 9
CHECKED BY:			



Altec Industries, Inc.
 210 Inverness Center Drive
 Birmingham, AL 35242

TITLE: SALES DRAWING
 LGS 132-84(81)

SCALE	REV	NUMBER	REV
1:25	2	980008337	A

NOTE: UNIT HIDDEN FOR CLARITY

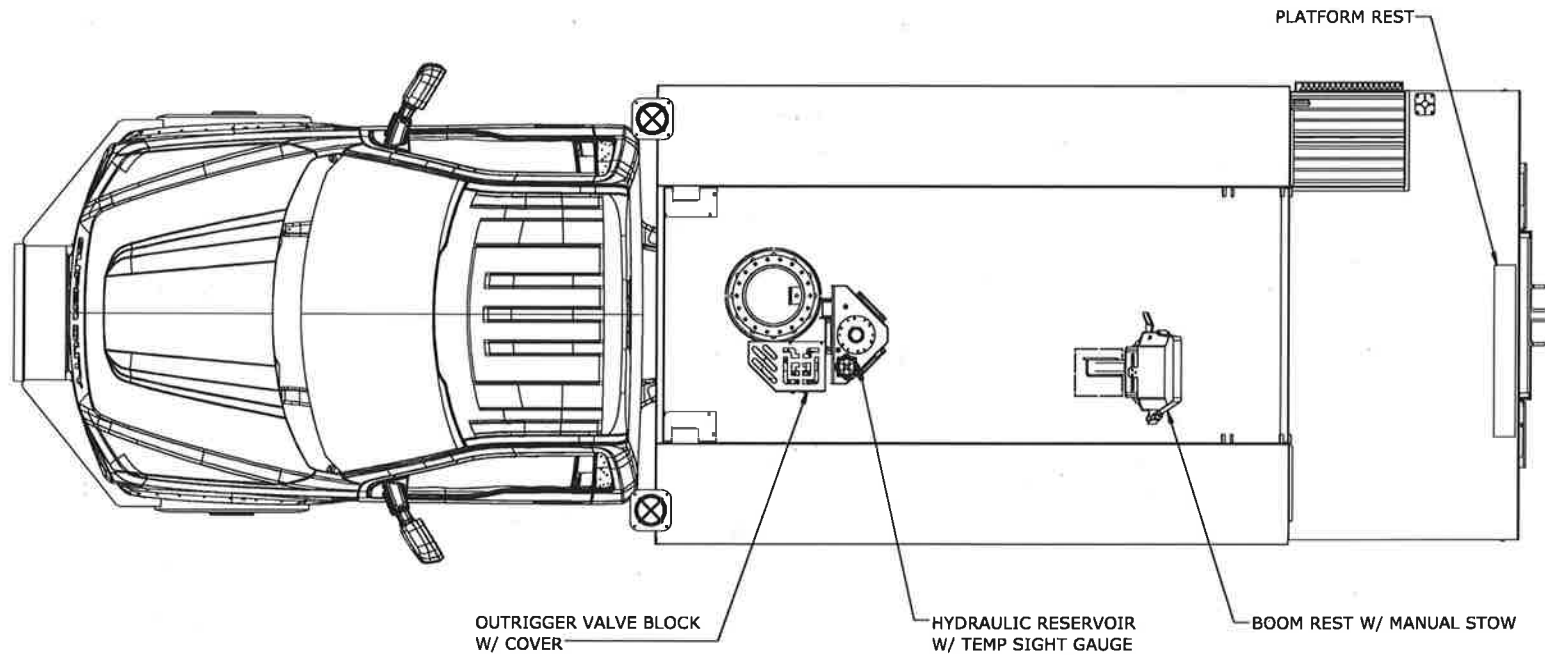

UNIT: AT41S
 SUBBASE HEIGHT: -
 BODY CROSSMEMBERS: -
 FLATBED CROSSMEMBERS: -
 CHASSIS MAKER: FORD
 CHASSIS MODEL: F550 4X2
 CHASSIS YEAR: 2022+

APPROVAL PRINT STAMP
☐ APPROVED
☐ APPROVED AS NOTED
☐ NOT APPROVED, CHANGE AS NOTED, RESUBMIT FOR APPROVAL.
 NOTE: ANY CHANGES MAY AFFECT PRICE
 RETURN OF APPROVAL PRINT REQ'D BY: -
 BY: _____ DATE: _____

RUN NO.: -

NOTES: DO NOT SCALE THIS PRINT. REMOVE ALL BURRS & SHARP EDGES. ALL DIMENSIONS ARE IN INCHES. CAD SOFTWARE: SOLIDWORKS.

CONFIDENTIAL:
 THIS DRAWING AND ITS CONTENTS ARE THE PROPRIETARY AND CONFIDENTIAL INFORMATION OF ALTEC INDUSTRIES, INC., AND ARE NOT TO BE REPRODUCED, COPIED, OR PUBLICLY DISCLOSED. IF THIS DRAWING IS PROVIDED TO A SOMEONE OUTSIDE ALTEC, IT IS DONE SO FOR THE LIMITED PURPOSE OF ASSISTING THAT RECIPIENT WITH A TECHNICAL OR PRODUCT ISSUE. IN RECEIVING THIS DRAWING, THE RECIPIENT AGREES TO MAINTAIN IT IN CONFIDENCE AND NOT TO USE IT BEYOND THE PURPOSE PREVIOUSLY STATED. RECIPIENT AGREES NOT TO REPRODUCE, COPY, OR PUBLICLY DISCLOSE THIS DRAWING AND ITS CONTENTS.

DRAWN BY:	NAME	DATE	SHEET
D. VENEGAS		02/04/2022	5 OF 9
CHECKED BY:			



Altec Industries, Inc.
 210 Inverness Center Drive
 Birmingham, AL 35242

TITLE:		SALES DRAWING		LGS 132-84(B1)	
SCALE	SHEET	NUMBER	REV	DATE	BY
1:25	2	980008337			A

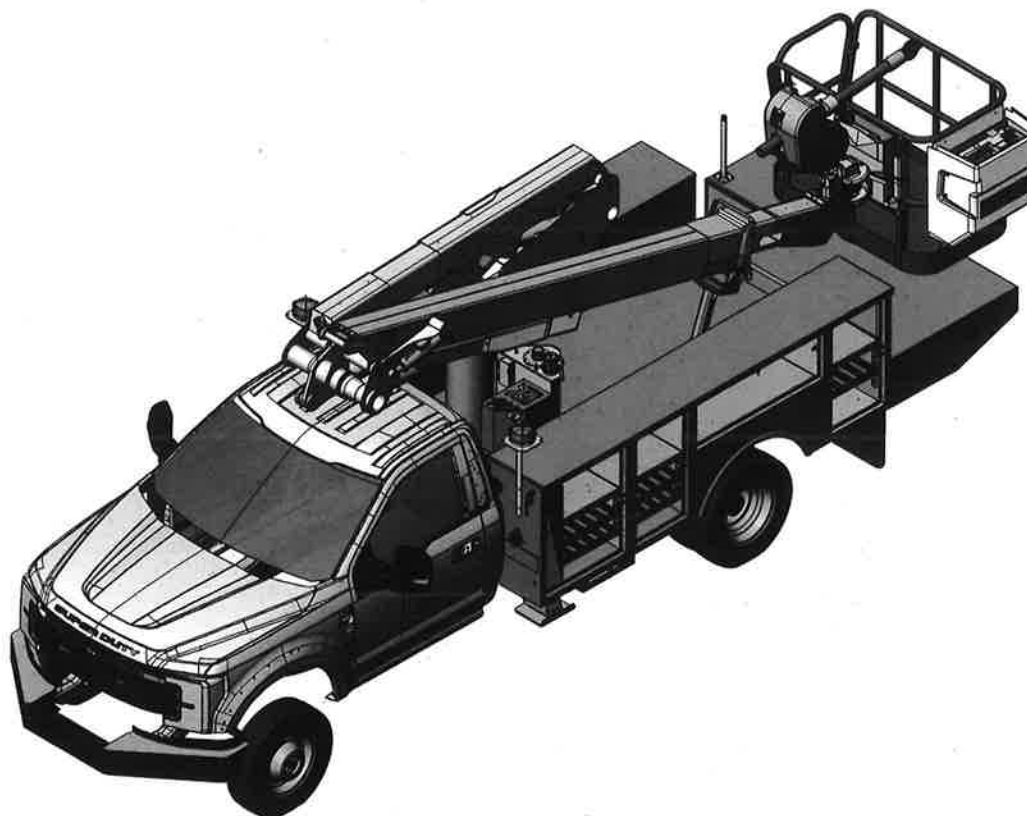

UNIT: AT41S
 SUBBASE HEIGHT: -
 BODY CROSSMEMBERS: -
 FLATBED CROSSMEMBERS: -
 CHASSIS MAKER: FORD
 CHASSIS MODEL: F550 4X2
 CHASSIS YEAR: 2022+

APPROVAL PRINT STAMP
☐ APPROVED
☐ APPROVED AS NOTED
☐ NOT APPROVED, CHANGE AS NOTED, RESUBMIT FOR APPROVAL.
 NOTE: ANY CHANGES MAY AFFECT PRICE
 RETURN OF APPROVAL PRINT REQ'D BY: -
 BY: _____ DATE: _____

RUN NO.: -

NOTES: DO NOT SCALE THIS PRINT. REMOVE ALL BURRS & SHARP EDGES. ALL DIMENSIONS ARE IN INCHES. CAD SOFTWARE: SOLIDWORKS.

CONFIDENTIAL
 THIS DRAWING AND ITS CONTENTS ARE THE PROPRIETARY AND CONFIDENTIAL INFORMATION OF ALTEC INDUSTRIES, INC., AND ARE NOT TO BE REPRODUCED, COPIED, OR PUBLICLY DISCLOSED. IF THIS DRAWING IS PROVIDED TO A SOMEONE OUTSIDE ALTEC, IT IS DONE SO FOR THE LIMITED PURPOSE OF ASSISTING THAT RECIPIENT WITH A TECHNICAL OR PRODUCT ISSUE. IN RECEIVING THIS DRAWING, THE RECIPIENT AGREES TO MAINTAIN IT IN CONFIDENCE AND NOT TO USE IT BEYOND THE PURPOSE PREVIOUSLY STATED. RECIPIENT AGREES NOT TO REPRODUCE, COPY, OR PUBLICLY DISCLOSE THIS DRAWING AND ITS CONTENTS.

NAME	DATE	SHEET
D. VENEGAS	02/04/2022	6 OF 9
CHECKED BY:		

Altec Altec Industries, Inc.
 210 Inverness Center Drive
 Birmingham, AL 35242

FILE: SALES DRAWING
 LGS 132-84(81)

SCALE	REV	NUMBER	REV
1:32	2	980008337	A

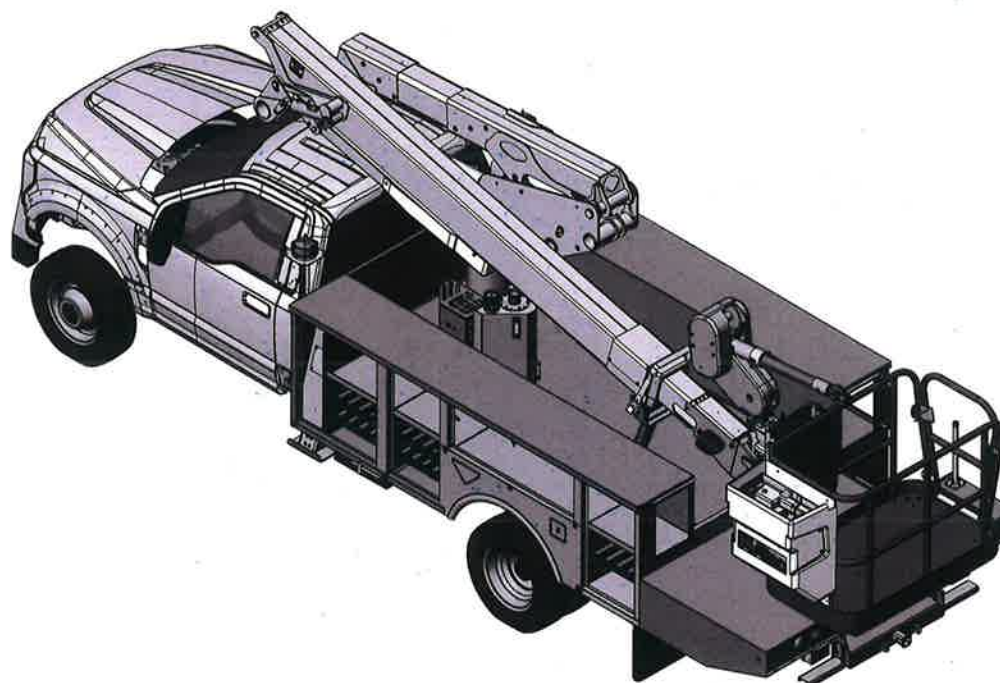

UNIT: AT41S
 SUBBASE HEIGHT: -
 BODY CROSSMEMBERS: -
 FLATBED CROSSMEMBERS: -
 CHASSIS MAKER: FORD
 CHASSIS MODEL: F550 4X2
 CHASSIS YEAR: 2022+

APPROVAL PRINT STAMP
☐ APPROVED
☐ APPROVED AS NOTED
☐ NOT APPROVED, CHANGE AS NOTED, RESUBMIT FOR APPROVAL
 NOTE: ANY CHANGES MAY AFFECT PRICE
 RETURN OF APPROVAL PRINT REQ'D BY: -
 BY: - DATE: -

RUN NO.: -

NOTES: DO NOT SCALE THIS PRINT, REMOVE ALL BURRS & SHARP EDGES, ALL DIMENSIONS ARE IN INCHES. CAD SOFTWARE: SOLIDWORKS.

CONFIDENTIAL
 THIS DRAWING AND ITS CONTENTS ARE THE PROPRIETARY AND CONFIDENTIAL INFORMATION OF ALTEC INDUSTRIES, INC., AND ARE NOT TO BE REPRODUCED, COPIED, OR PUBLICLY DISCLOSED. IF THIS DRAWING IS PROVIDED TO A SOMEONE OUTSIDE ALTEC, IT IS DONE SO FOR THE LIMITED PURPOSE OF ASSISTING THAT RECIPIENT WITH A TECHNICAL OR PRODUCT ISSUE. IN RECEIVING THIS DRAWING, THE RECIPIENT AGREES TO MAINTAIN IT IN CONFIDENCE AND NOT TO USE IT BEYOND THE PURPOSE PREVIOUSLY STATED. RECIPIENT AGREES NOT TO REPRODUCE, COPY, OR PUBLICLY DISCLOSE THIS DRAWING AND ITS CONTENTS.

DRAWN BY:	NAME	DATE	SHEET
D. VENEGAS		02/04/2022	7 OF 9
CHECKED BY:			



Altec Industries, Inc.
 210 Inverness Center Drive
 Birmingham, AL 35242

SCALE	SHEET	NUMBER	REV
1:32	2	980008337	A

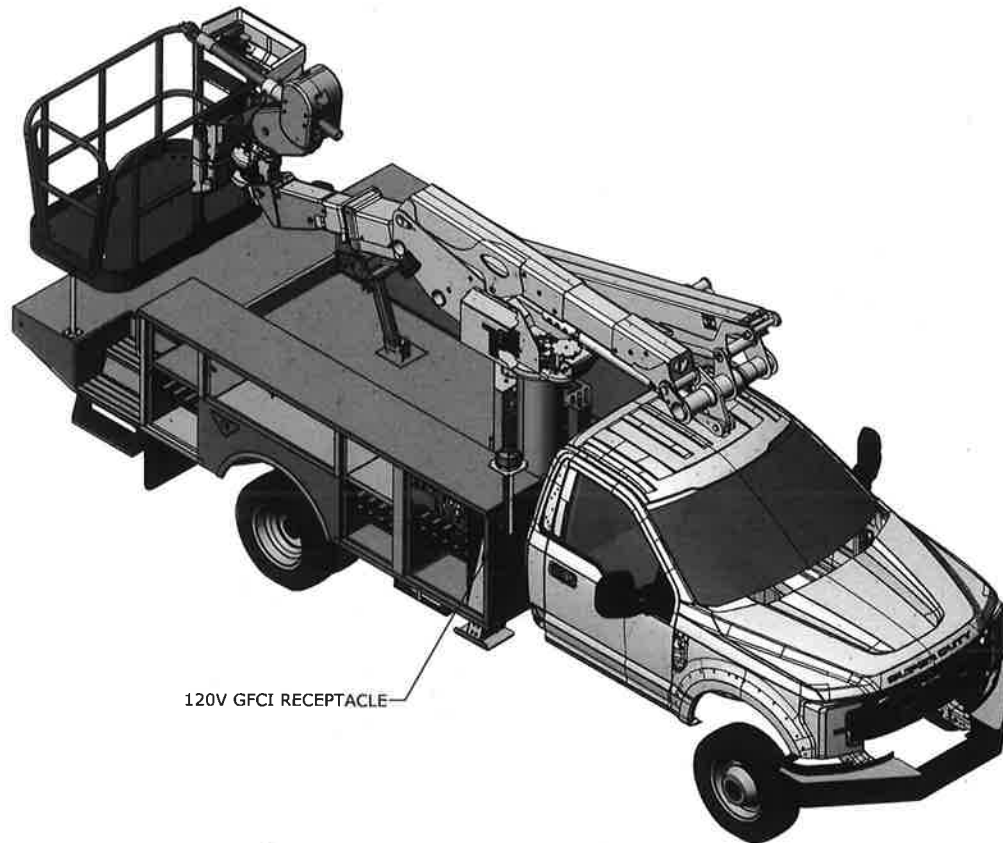

120V GFCI RECEPTACLE

UNIT: AT41S
 SUBBASE HEIGHT: -
 BODY CROSSMEMBERS: -
 FLATBED CROSSMEMBERS: -
 CHASSIS MAKER: FORD
 CHASSIS MODEL: F550 4X2
 CHASSIS YEAR: 2022+

APPROVAL PRINT STAMP

- ☐ APPROVED
☐ APPROVED AS NOTED
☐ NOT APPROVED, CHANGE AS NOTED,
 RESUBMIT FOR APPROVAL.

NOTE: ANY CHANGES MAY AFFECT PRICE

RETURN OF APPROVAL PRINT REQ'D BY: -
 BY: _____ DATE: _____

RUN NO.: -

NOTES:

DO NOT SCALE THIS PRINT, REMOVE ALL BURRS & SHARP
 EDGES, ALL DIMENSIONS ARE IN INCHES.
 CAD SOFTWARE: SOLIDWORKS.

CONFIDENTIAL
 THIS DRAWING AND ITS CONTENTS ARE THE PROPRIETARY AND
 CONFIDENTIAL INFORMATION OF ALTEC INDUSTRIES, INC., AND ARE
 NOT TO BE REPRODUCED, COPIED, OR PUBLICLY DISCLOSED. IF THIS
 DRAWING IS PROVIDED TO A SOMEONE OUTSIDE ALTEC, IT IS DONE
 SO FOR THE LIMITED PURPOSE OF ASSISTING THAT RECIPIENT WITH A
 TECHNICAL OR PRODUCT ISSUE. IN RECEIVING THIS DRAWING, THE
 RECIPIENT AGREES TO MAINTAIN IT IN CONFIDENCE AND NOT TO
 USE IT BEYOND THE PURPOSE PREVIOUSLY STATED. RECIPIENT
 AGREES NOT TO REPRODUCE, COPY, OR PUBLICLY DISCLOSE THIS
 DRAWING AND ITS CONTENTS.

NAME	DATE	SHEET
D. VENEGAS	02/04/2022	8 OF 9
CHECKED BY: <u>-</u>		



Altec Industries, Inc.
 210 Inverness Center Drive
 Birmingham, AL 35242

FILE:

SALES DRAWING
 LGS 132-84(81)

SCALE	SYS	NUMBER	REV
1:32	2	980008337	A

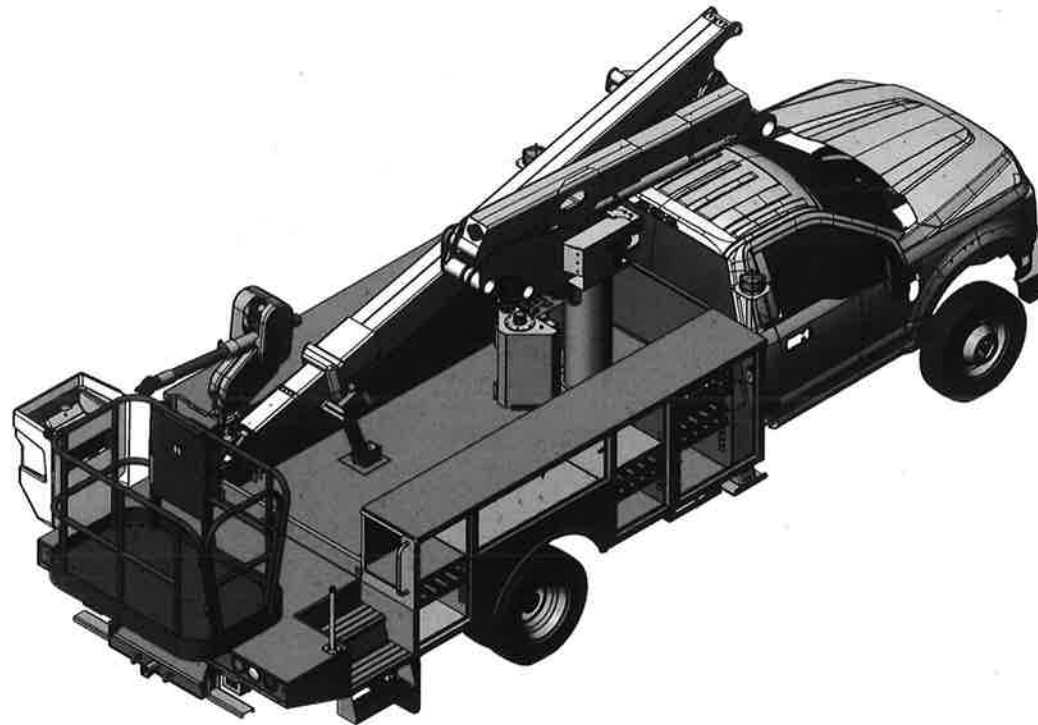

UNIT: AT41S
 SUBBASE HEIGHT: -
 BODY CROSSMEMBERS: -
 FLATBED CROSSMEMBERS: -
 CHASSIS MAKER: FORD
 CHASSIS MODEL: F550 4X2
 CHASSIS YEAR: 2022+

APPROVAL PRINT STAMP
☐ APPROVED
☐ APPROVED AS NOTED
☐ NOT APPROVED, CHANGE AS NOTED, RESUBMIT FOR APPROVAL.
 NOTE: ANY CHANGES MAY AFFECT PRICE
 RETURN OF APPROVAL PRINT REQ'D BY: -
 BY: _____ DATE: _____

RUN NO.: _____

NOTES: DO NOT SCALE THIS PRINT, REMOVE ALL BURRS & SHARP EDGES, ALL DIMENSIONS ARE IN INCHES.
 CAD SOFTWARE: SOLIDWORKS.

CONFIDENTIAL
 THIS DRAWING AND ITS CONTENTS ARE THE PROPRIETARY AND CONFIDENTIAL INFORMATION OF ALTEC INDUSTRIES, INC., AND ARE NOT TO BE REPRODUCED, COPIED, OR PUBLICLY DISCLOSED. IF THIS DRAWING IS PROVIDED TO A SOMEONE OUTSIDE ALTEC, IT IS DONE SO FOR THE LIMITED PURPOSE OF ASSISTING THAT RECIPIENT WITH A TECHNICAL OR PRODUCT ISSUE. IN RECEIVING THIS DRAWING, THE RECIPIENT AGREES TO MAINTAIN IT IN CONFIDENCE AND NOT TO USE IT BEYOND THE PURPOSE PREVIOUSLY STATED. RECIPIENT AGREES NOT TO REPRODUCE, COPY, OR PUBLICLY DISCLOSE THIS DRAWING AND ITS CONTENTS.

DRAWN BY:	NAME	DATE	SHEET
D. VENEGAS		02/04/2023	9 OF 9

SCALE	SHEET	NUMBER	REV
1:32	2	980008337	A

Altec Industries, Inc.
 210 Inverness Center Drive
 Birmingham, AL 35242

SALES DRAWING
 LCS 132-84(81)

A technical line drawing of a long, narrow metal box, likely a toolbox or equipment case. The box is shown from a three-quarter perspective with its lid open. The lid features two internal compartments, each with a handle. The main body of the box has two latches on the front edge. The drawing is a black and white line art, typical of technical manuals.

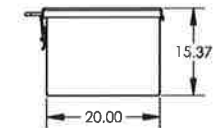
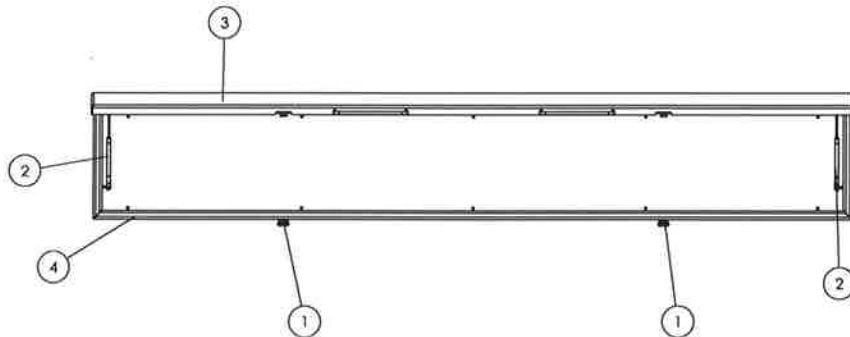

5	26	970253719	BOX SEAL, SELF ADHESIVE, RUBBER
4	1	990515689	BOX WELDMENT, TOP OPENING BOX, .125 ALUMINUM TREADPLATE, 132.00 IN L, 20.00 IN W, 15.00 IN H
3	1	990515688	LID WELDMENT, TOP OPENING BOX, .125 ALUMINUM TREADPLATE, 132.84 IN L, 21.11 IN W, 1.63 IN H
2	2	990145295	GAS PROP.:9.54 IN L;.60 IN DIA;:15.04 IN L EXTENDED;:23 IN DIA ROD;30 LB;
1	2	990144700	PADLOCK CAM-LEVER HASP, PADLOCKABLE, ADJUSTABLE, STANDARD STEEL
ITEM	QTY	PART NUMBER	DESCRIPTION
DRAWN BY: B.WILCOX APPROVED BY: DATE: 10/23/2017 REVISED:			REVISIONS:  <p>Aitec (Osceola Body Plant) 1001 Furness Drive Osceola, IA 50213</p>
TITLE: TOP OPENING BOX ASSEMBLY, .125 ALUMINUM TREADPLATE, 132.00 IN L, 20.00 IN W, 15.00 IN H			SCALE: 1:16 WEIGHT: 201.2 SIZE: 3 NUMBER: 990515690 REV: A